

DID YOU KNOW?

GROUP AND CONVENTIONS FACT SHEET



For conference and exhibition planners there is only one place to meet.

Whether it's a boardroom meeting, trade show or banquet, our venues, facilities and attention to personal service, set us apart.

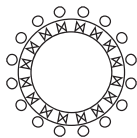

Catering for groups of 8 to 3 000

Emperors Palace excels in three essential ingredients for successful conferences and events: superb cuisine, impeccable service, and an elegant atmosphere.

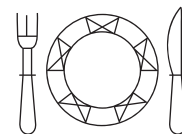

The Exhibition and Conference Centre at Emperors Palace provides a diverse range of exciting, multi-purpose venues, as well as small executive breakaway rooms.

The entire venue has extensive technical resources and is equipped with state-of-the-art facilities including free wi-fi.



Four Award Winning Hotels - from 3 to 5 Star



5-star Peermont D'oreale Grande

features 182 beautifully designed and impeccably appointed rooms and suites that are fitted with luxurious facilities.

The Club Floor and Lounge offers a full bouquet of personal and concierge services dedicated to the elite business traveller. Dine at the elegant Aurelia's Restaurant, indulge your senses at Octavia's Day Spa or sip on cocktails while watching the African at Neptune's Pool Bar.



4-star Peermont Mondior hotel

sets an exciting standard in world-class business, conference and leisure accommodation. The hotel features 150 spacious rooms and suites furnished in contemporary African elegance and fitted with cutting-edge technology. Enjoy breakfast and light meals at the chic Oriana Restaurant or a sociable cocktail at the Silver Moon bar.



The 3-star Peermont Metcourt

offers 348 stylish and comfortable rooms ideal for corporate, convention and leisure guests. Enjoy breakfast at the F.L.A.G. Café or sip on a soothing drink at the 21 Degrees cocktail bar. A boardroom and business centre are available for residents' exclusive use.

Easily Accessible - Location and Transport

Emperors Palace is conveniently situated next to the O.R. Tambo International Airport in Johannesburg with a FREE shuttle service operating every 20 minutes between 06h00 and 23h00 daily.

Private VIP and after hours transfers can be arranged at an additional cost through Unicab on 011 928 1762.

The Rhodesfield Gautrain station is minutes away providing access to O.R. Tambo International Airport Pretoria, Sandton, Johannesburg and Pretoria. Gautrain busses operate a route directly from the Rhodesfield station to Emperors Palace weekdays from 05h30 to 20h00.

Emperors Palace GPS co-ordinates: S: 26° 08' 55.10" E: 28° 13' 20.17"

Directions from Johannesburg

- Take the R24 towards O.R. Tambo International Airport.
- At the airport, the road splits - keep to the left lane and follow the R21 East Rand/Boksburg lane.
- Follow the road until you reach Griffiths Road off-ramp, turn left at the top of the bridge.
- At the T-junction, turn left into Jones Rd.
- Entrance to Emperors Palace is on your left.

Directions from Pretoria

- Take the R21 towards O.R. Tambo International Airport. Follow the JHB directions.

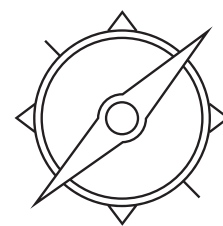

Studio Iris





Studio Iris is our Live Streaming Broadcast Studio, which lets you broadcast your message directly to your target audience, no matter where they are in the country - or world. This state of the art and fully customisable studio allows you to harness technology and get your message out effectively and professionally, whether it is for business, entertainment or private functions.

Olympus Sky Bar

Located above the Peermont Metcourt Hotel, this upmarket sky bar has the perfect ambience to enjoy the African sunset and sparkling city lights. It boasts 3 distinct entertainment areas, including a new 108m² composite timber deck with a pergola roof. Ideal for private functions and celebratory events.

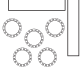
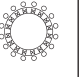
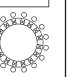
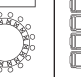
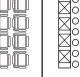
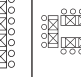
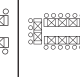
Conference Room Dimensions, Seating and Capacity Information

	Dimensions	Dimensions	FLOOR LOADING	COCKTAIL	BANQUET	BUFFET	BUFFET & DANCE FLOOR	CINEMA	SCHOOL ROOM	U-SHAPE	BOARD ROOM
	AREA IN METRES (M)	AREA M ²	KG PER M ²								
Theodora Boardroom Boardroom reception	11,3 X 6,9 6,9 X 2,8	80 23	200	N/A	N/A	N/A	N/A	N/A	N/A	N/A	20
Assembly Rooms	42,8 X 39,2	1 656	200	1 200	1 000	800	650	1 200	800	N/A	N/A
Assembly I	32,8 X 18,2	602	200	N/A	N/A	N/A	N/A	N/A	N/A	N/A	N/A
Assembly I & II	32,8 X 39,2	1 288	200	800	700	500	450	1 000	700	N/A	N/A
Assembly II	32,8 X 20,8	686	200	600	400	300	270	800	450	N/A	80
Assembly III	10,3 X 8,5	87	200	50	40	N/A	N/A	60	40	20	30
Assembly IV	10,3 X 13,9	133	200	80	80	60	N/A	80	60	40	40
Assembly V	10,3 X 7,3	75	200	50	N/A	N/A	N/A	50	30	15	20
Assembly VI	10,3 X 8,5	87	200	50	40	N/A	N/A	60	40	20	30
NCC	15,7 X 29,3	459	200	400	230	200	180	400	250	60	N/A
Senate Rooms	29,5 X 29,3	864	200	800	450	350	300	800	600	N/A	N/A
Senate I	13,5 X 29,3	395	200	300	250	150	150	400	200	50	N/A
Senate II	15,7 X 29,3	459	200	400	230	200	180	400	250	60	N/A
Augustus Room	7,6 X 11,8	87	200	60	40	N/A	N/A	60	40	25	30
Claudius Room	7,7 X 11,8	87	200	60	40	N/A	N/A	60	40	25	30
Romanus Room	7,6 X 11,8	87	200	60	40	N/A	N/A	60	40	25	30
Tiberius Room	7,6 X 11,8	87	200	60	40	N/A	N/A	60	40	25	30
Florian Room	7,6 X 11,8	87	200	60	40	N/A	N/A	60	40	25	30
Fabia Rooms	26,4 X 15,1	398	200	300	200	150	300	150	250	60	N/A
Fabia I	12 X 15,1	181	200	130	100	80	60	140	100	50	50
Fabia II	14,4 X 15,1	217	200	130	100	80	60	140	120	50	50
Julia Room	13,4 X 15,1	202	200	130	100	80	60	140	100	60	N/A
Lucretia Rooms	14,2 X 12,1	172	200	100	100	70	N/A	100	70	40	50
Lucretia I	7,1 X 12,1	86	200	60	40	N/A	N/A	60	40	25	30
Lucretia II	7,1 X 12,1	86	200	60	40	N/A	N/A	60	40	25	30
Marcia Rooms	14,9 X 11,8	178	200	100	100	70	N/A	100	70	40	50
Marcia I	7,1 X 11,8	84	200	60	40	N/A	N/A	60	40	25	30
Marcia II	7,8 X 12,1	94	200	60	40	N/A	N/A	60	40	25	50
Centre Court	38,2 X 70,5	2 698	1 000	2 500	1 500	1 100	800	3 000	1 500	N/A	N/A
Theatre Of Marcellus	25,6 X 32	820	1 000	N/A	N/A	N/A	N/A	910	N/A	N/A	N/A
The Pantheon (Cinema I)	20,4 X 36,8	786	200	N/A	N/A	N/A	N/A	517	N/A	N/A	N/A
Cinema V	11,4 X 19,6	237	200	N/A	N/A	N/A	N/A	173	N/A	N/A	N/A
Cinema VI	16,8 X 17	297	200	N/A	N/A	N/A	N/A	167	N/A	N/A	N/A
Red Roman Shed interior External Area		1575 307	800	800 in bench-style seating							

- The above seating styles are applicable for wall to wall seating only.
- They do not include technical equipment, head table, staging or dance floor.
- All events are subject to Health and Safety approval.
- A tiered seating solution is available for the Centre Court at an additional charge.

Technical Daily Delegate Package

Emperors Palace offers a technical daily delegate package that includes:

- Audio Visual: a data projector with necessary cabling, a screen and laptop audio cable
- Audio: A PA System including amplifiers and cabling, mixing desk and a wired podium microphone.

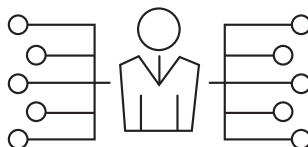

Set-up of the equipment and a standby technician is included. Should a technician be required to remain at the venue for the duration of the event, a quotation will be supplied.

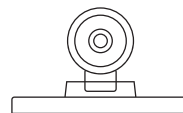

Conference Equipment

Each conference room includes the following facilities: dimmable room lighting, individual controls for each room and a lectern. Additional equipment required can be hired at an additional cost.

Centre Court

This incredibly versatile 2 698m² venue is ideal for very large banquets for up to 1500 people – sporting and musical events, exhibitions, seminars and product launches. Centre Court has a pre-assembly area, dressing rooms, under-floor power supply and overhead telephone lines as well as access for vehicles not exceeding 2,2m in height. A separate fully serviced smoking lounge is adjacent to the venue.



State-Of-The-Art Technology

The South Wing boasts state-of-the-art presentation technology with HD content viewing from laptops, tablets or smartphones. Each conference room has an HD projector and ceiling mounted screen with interactive controls.

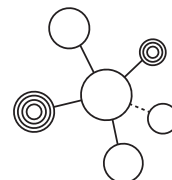

Energy efficient smart lighting is available in all the rooms with a central control system, allowing for automatic and manual adjustments to suit the mood of the presentation. Digital signage through the Convention Centre directs delegates with ease.

South Wing

The South Wing is your first vantage point for the Convention Centre upon entrance and offers beautifully adorned pre-assembly areas and an elegant reception area. 13 venues are available in this Wing with the Negotiating Council Chamber (NCC), Senate Room I and Senate Room II, each able to accommodate up to 300 delegates in cinema style. Senate Rooms I and II can also be combined for larger functions.

The Fabia I and II and Julia Rooms can accommodate 130 guests each while the Marcia I and II and Lucretia I and II Rooms can accommodate 60 people each. Fabia, Marcia and Lucretia can be combined for increased capacity.

There are five smaller meeting rooms, Claudius, Augustus, Tiberius, Florian and Romanus Rooms, and the Basilica Boardroom, which are all ideal for use as executive boardrooms and breakaway meetings.

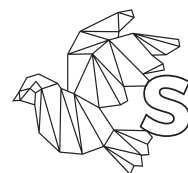

NORTH WING



The North Wing, comprises the large Assembly Room, which is sub-divisible into six separate venues. Its capacity therefore ranges from 30 to 2000 delegates, depending on the style of the set-up, and the combined space of 1 656 m² is ideal for large conferences, banquets and product launches.

Nu Metro Cinemas

Nu Metro Emperors Palace is an all-digital cinema complex and boasts one of the largest cinemas on the African continent. Host your next conference, special function, exclusive preview or live broadcast and live the epitome of the cinematic experience.

Theatre Of Marcellus

This superbly appointed theatre, just off the main Casino floor, is the ideal venue for presentations, stage productions and awards ceremonies. The theatre can accommodate over 1000 people, has plush flip-arm seating, a VIP area and excellent sight lines. The theatre also offers a magnificent stage with vehicle access.

THEODORA CONFERENCE ROOM

Inspired by the Empress Theodora, this high-tech boardroom allows you to host meetings, conference calls or strategy sessions of up to 20 people, while opening up channels to incorporate associates and partners both locally and internationally. Complete with 86" screens, wireless technology and fully compatible with all devices, this is the future of conferencing.

Weddings And Honeymoons

Between March and October, the intimate Garden Gazebo at the Peermont D'oreale Grande hotel as well as the Convention Centre offer elegant and romantic settings for the perfect wedding ceremony. For more information on our wedding services, please contact 011 928 1103.

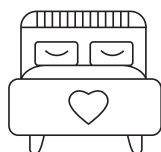

The Red Roman Shed

This eclectic venue with its metal and concrete industrial feel is the ideal place to hold non-traditional events - exhibitions, fairs, group fitness events, sports screenings, beer and wine festivals and more. Situated close the multi-level parkade, the Red Roman Shed can seat over 800 people in bench-style seating.

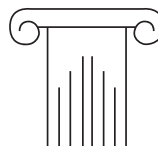

Convention Centre Floor Plan

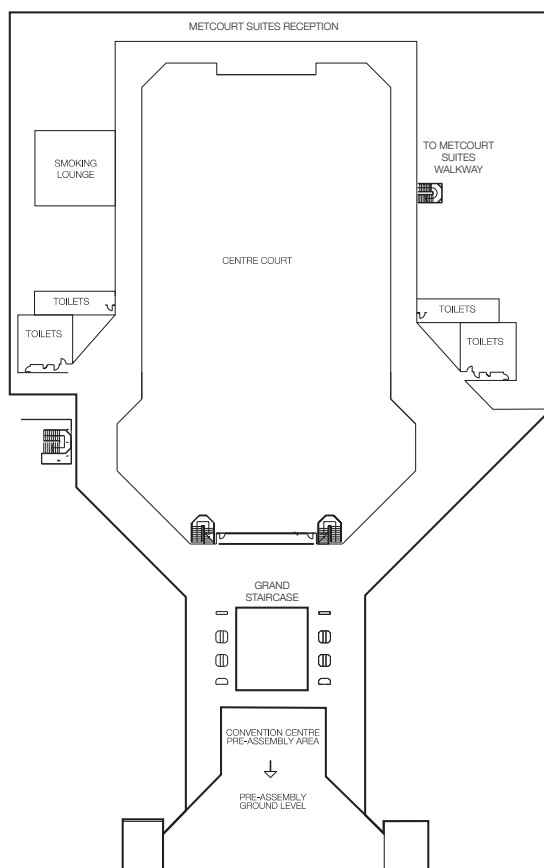
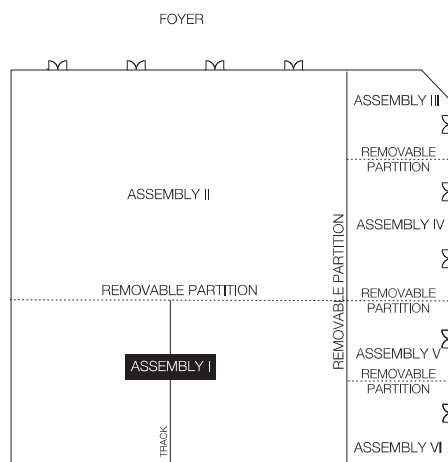

New South Wing Floor Plan

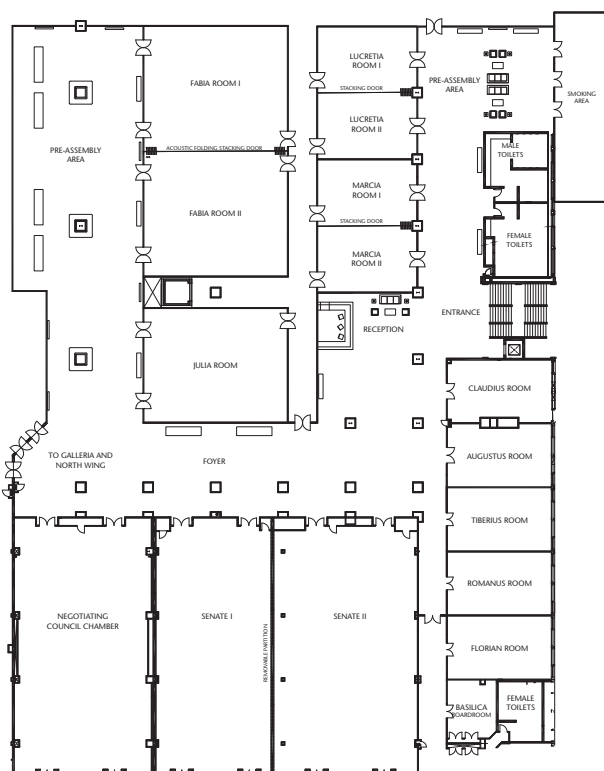

Nu Metro Floor Plan

