

# DID YOU KNOW?

## Group and conventions fact sheet

### Conveniently situated in Gaborone,

The Grand Palm Hotel, Casino and Convention Resort, offers luxury accommodation, dazzling entertainment and a variety of convention facilities, underpinned by Botswana hospitality. The facilities of The Grand Palm incorporate the world-class Gaborone International Convention Centre.



#### Peermont Walmont Hotel Accommodation

This elegant 5-star hotel offers Botswana's highest standards of hospitality. The Peermont Walmont hotel is choicely designed and thoughtfully decorated for both business and leisure guests and is equipped with all the facilities and modern conveniences that discerning travelers have come to expect.



#### Peermont Metcourt Inn Accommodation

The Peermont Metcourt Inn is a modern 3-star select services hotel that offers cosy, comfortable, affordable accommodation and delightful service. Guests at the Peermont Metcourt Inn are welcome to utilize any of the facilities at The Grand Palm resort as inter-charges are possible..

### Baishen Asian Restaurant

The Bai Sheng Restaurant offers Asian fare to the local Gaborone resident or western traveller who is familiar with the Chinese menu. The Restaurant is stylishly eclectic offering exquisite traditional Chinese artworks and artefacts set against chic, contemporary lines. Bai Sheng offers seating for up to 148 diners, the main restaurant area, three luxury private dining rooms and covered exterior, which is enclosed with bamboo and overlooks the hotel's beautifully landscaped gardens. The menu is Halaal friendly and caters for vegetarians.

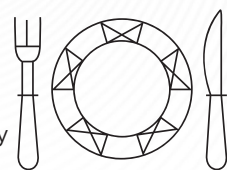

- Hours: 18h30 to 22h30 - Tuesdays to Sundays
- Dress : Smart Casual
- Capacity : 148
- Reservations : +267 363 7777
- Smoking area in outdoor courtyard.
- For large groups a set menu can be organised.

### The Beef Baron Grill and Rib Room

Combining olde-world charm with an east African ambience, this beautifully appointed restaurant serves a delectable à la carte menu specialising in prime Botswana beef cuts, and a choice selection of international wines.

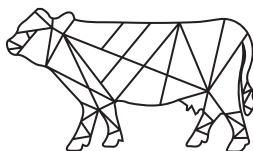

- Hours: 18h30 to 22h30 - Dinner, Closed on Sunday
- Dress: Smart Casual
- Capacity: 120
- Reservations: +267 363 7777
- No children under 12.
- Non-smoking area and smoking area on outside terrace.

### F.L.A.G. CAFÉ

F.L.A.G. Café is situated on the ground floor of the Peermont Metcourt Inn. This breakfast restaurant's double volume space is in vibrant shades of red and orange with a distinctly retro feel. Guests can enjoy a simplified full English breakfast, and in the evenings the counter seating is utilized as bar seating.

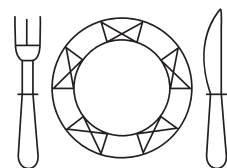

- Hours: 06h00 to 10h30 - Monday to Friday
- 07h00 to 10h00 - Saturday, Sunday and Public Holidays
- Dress: Casual
- Capacity: 102 (70 indoor, 32 outdoor)
- Smoking and non-smoking area

### Mokolwane Bistro

This modern African restaurant, named after the indigenous Mokolwane palm tree, offers an international buffet. It also features private dining areas and has a magnificent view of the hotel gardens.

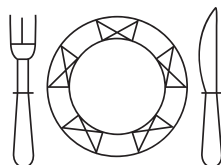

- Hours: 06h30 to 10h30 - Breakfast
- 06h30 to 11h00 - Breakfast (Saturday & Sunday)
- 12h30 to 14h30 - Lunch
- 18h30 to 22h30 - Dinner
- Dress: Smart Casual
- Capacity: 204
- Reservations: +267 363 7777 - For groups of 10 or more
- Smoking and non-smoking area Indoor and outdoor seating

## The Boma

A true African outdoor setting adjacent to the picturesque lake where you can dine under the African Skies, and enjoy the energy of a traditional bonfire. Private dining for groups only. Banqueting buffet menu available

- Capacity: 30 to 90 people (Minimum of 30 people to book)
- Reservations: +267 363 7777 - Venue is booked through the GICC

## Oasis Deli

The casino features the Oasis Deli, offering players a bite to eat without having to leave the casino floor.

## Oasis Bar

Cocktail bar situated on the casino floor.

- Hours: 24 hours (open to players only, closed from 02h00 to 08h00 to cash customers)

## The Kalahari Cocktail Bar

An elegant and private cocktail bar set in a horseshoe design that offers a choice of light snacks and pastries. There is a smoking terrace looking out onto the gardens.

- Hours: 06h00 to 23h00



## The Fig Tree

This restaurant is located on the pool terrace in a true African bushveld setting under a thatched pool bar with clustered thatch umbrella seating. A selection of meals and cocktail drinks are served.

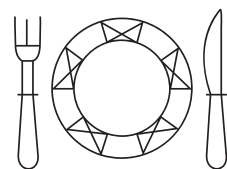

- Hours: 09h00 to 21h00 (summer), 09h00 to 19h00 (winter)
- Capacity: 60
- Smoking and non-smoking area

## Childrens Play Gym

There is an outdoors children's play gym adjacent to the Fig Tree.

Parents can enjoy the tranquil Fig Tree setting watching their children nearby.

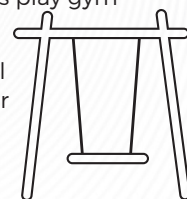

## Camelot Spa

Reflecting an ambience of professionalism and luxury, Camelot Spa at Grand Palm offers a range of spa treatments and therapies to de-stress, re-energise and transform your body, mind and soul into a phase of rejuvenation and wellness. Facilities include a Hydrobath, Vichy Shower, Manicure & Pedicure Lounge, Relax Room and 6 treatment rooms.

## CONFERENCE ROOM DIMENSIONS, SEATING AND CAPACITY INFORMATION

### THE GRAND PALM CONVENTION ROOMS

	DIMENSIONS	DIMENSIONS	DIMENSIONS	COCKTAIL	BANQUET	CINEMA	SCHOOLROOM	U-SHAPE	BOARDROOM
	AREA IN METERS (M)	AREA M²	CEILING HEIGHT (MIN/MAX) IN METRES (M)						
OKAVANGO SUITE	17,5 X 17,5	306	3	150	200	250	220	80	N/A
OKAVANGO 1 OR 2	17,5 X 8,7	152	3	75	100	150	120	40	N/A
MOREMI SUITE	17 X 7,5	119	2,5	60	80	100	60	40	30
MOREMI 1,2 OR 3	5,5 X 7,5	40	2,5	20	20	35	20	12	12







The above seating styles are applicable for wall to wall seating only. They do not include technical equipment, staging or dance floor.

### THE GICC – TSODILO SUITE

	DIMENSIONS	DIMENSIONS	DIMENSIONS	COCKTAIL	BANQUET	CINEMA	SCHOOLROOM	U-SHAPE	BOARDROOM
	AREA IN METERS (M)	AREA M²	CEILING HEIGHT (MIN/MAX) IN METRES (M)						
TSODILO SUITE	29,5 X 52,5	1 550	8,5 / 9,5	1 550	1 040	1 807	1 002	700	1500
HALL A	29,5 X 12,5	595	8,5 / 9,5	590	350	588	360	290	390
HALL B	29,5 X 20,2	595	8,5 / 9,5	590	350	588	360	200	360
HALL C	29,5 X 20,2	368	8,5 / 9,5	370	200	396	192	120	192
HALL B1 + B2	14,8 X 20,2	298	8,5 / 9,5	300	200	308	180	140	180
HALL B4	14,8 X 12,6	187	8,5 / 9,5	190	90	162	105	80	100

The above seating styles are applicable for wall to wall seating only. They do not include technical equipment, staging or dance floor.

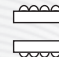
THE GICC – SERONDELA ROOMS AND SAN-TA-WANI VIP SUITE

	DIMENSIONS	DIMENSIONS	DIMENSIONS	COCKTAIL	BANQUET	CINEMA	SCHOOLROOM	U-SHAPE	BOARDROOM
	AREA IN METERS (M)	AREA M²	CEILING HEIGHT (MIN/MAX) IN METRES (M)						
SERONDELLA ROOMS (ALL)	7,8 X 19,2	180	3,8 / 4,2	150	120	120	108	70	45
SERONDELLA ROOMS 1 & 2 OR 3&4	7,8 X 9,6	75	3,8 / 4,2	75	60	60	45	20	36
INDIVIDUAL SERONDELLA ROOMS	7,8 X 4,8	37,5	3,8 / 4,2	38	20	30	21	10	18
TSODILO SUITE BALCONY	N/A	130	3.05	80	N/A	N/A	N/A	N/A	N/A
SAN-TA-WANI BOARDROOM & LOUNGE	9.8 X 9.8	96	3.3 X 3.6	40	N/A	N/A	N/A	N/A	20

The above seating styles are applicable for wall to wall seating only. They do not include technical equipment, staging or dance floor.

THE GICC UPPER LEVEL CONVENTION FACILITIES LAYOUT

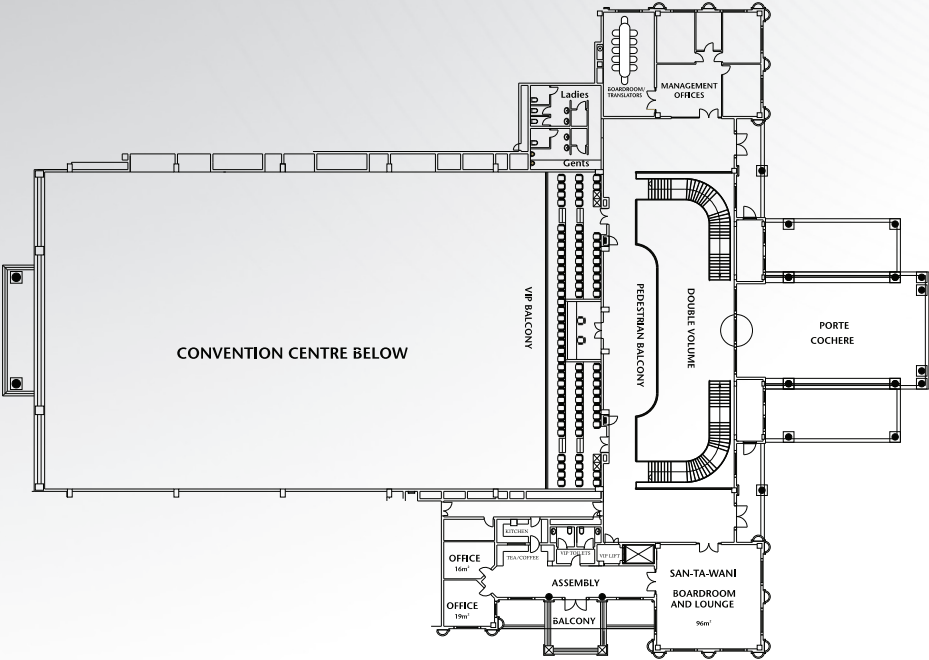

THE GRAND PALM CONVENTION FACILITIES LAYOUT

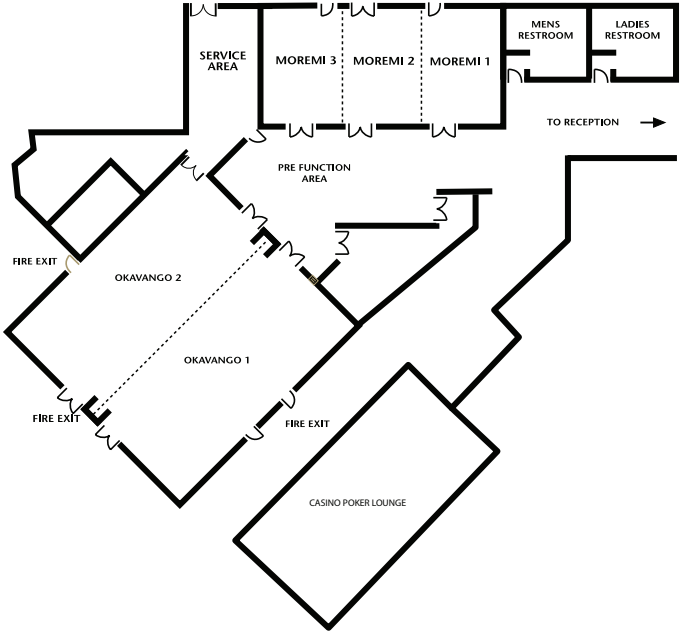

# THE GICC GROUND FLOOR CONVENTION FACILITIES LAYOUT

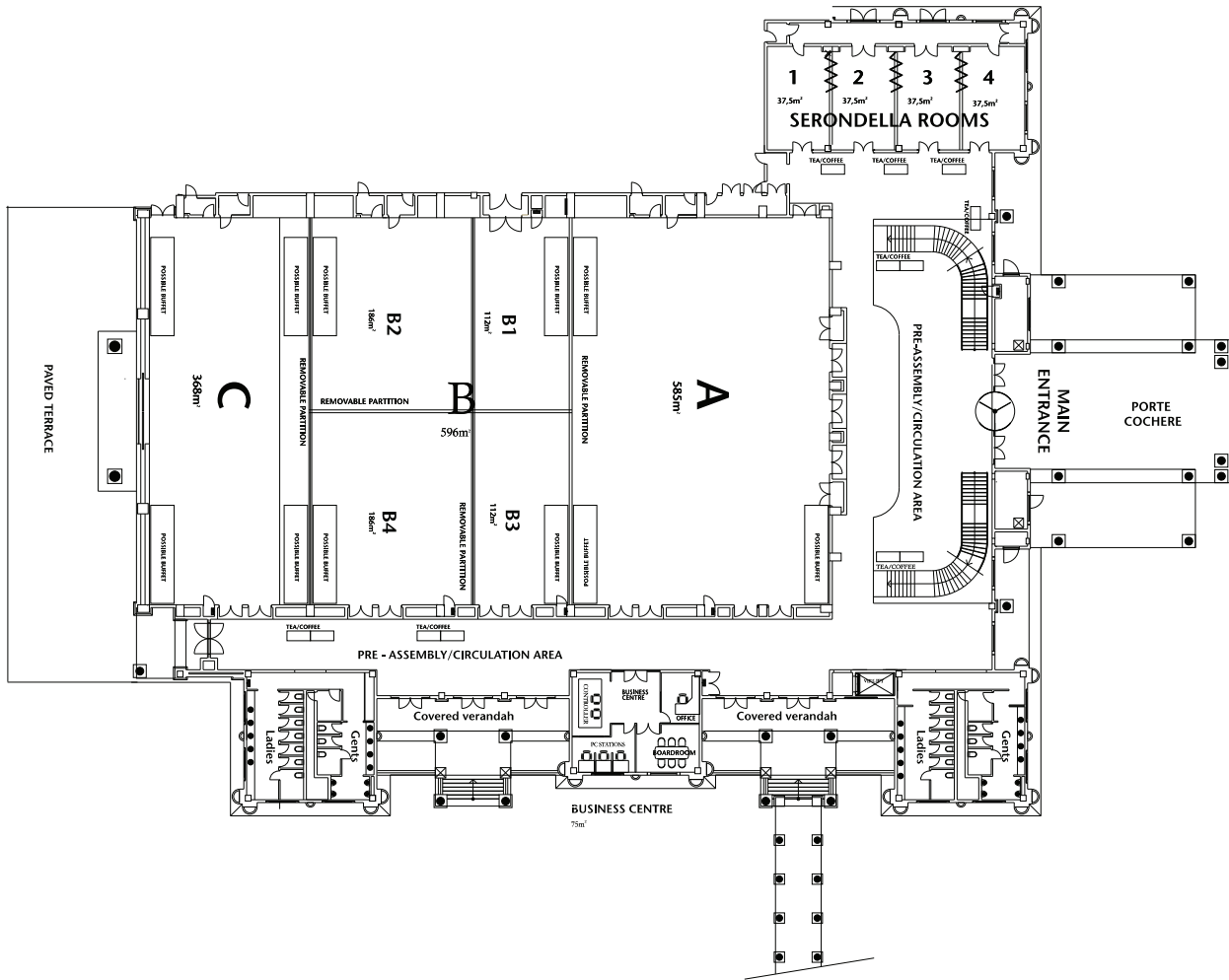

## Local Map

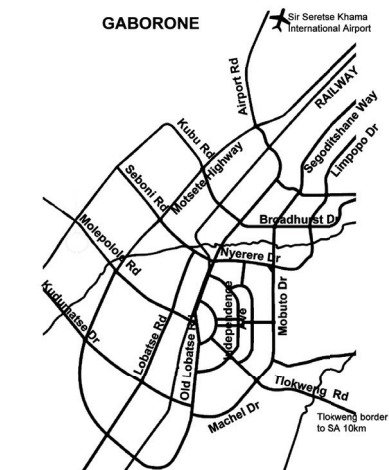

## Regional Map

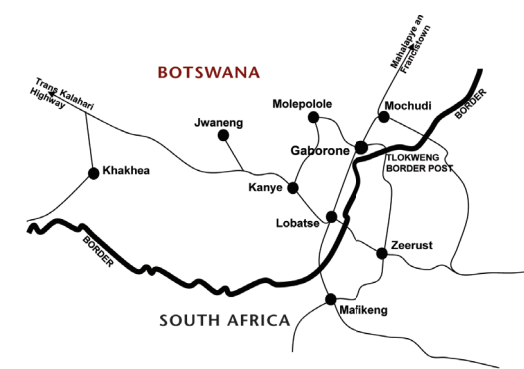

## Location

The Grand Palm Hotel, Casino and Convention Resort is situated in the city of Gaborone in Southern Botswana. (Malaria free area)

### Directions

GPS co-ordinates: S: 24° 38' 27.16" | E: 25° 52' 46.55"



**ADDRESS**  
Bonnington Farm, Molepolole Road,  
Gaborone, Botswana  
Private Bag BR105, Gaborone, Botswana  
T: +267 363 7777  
F: +267 391 2989  
info@grandpalm.bw  
www.grandpalm.bw

**PEERMONT GROUP SALES**  
T +27 (0)11 928 1903  
sales@peermont.com

**PEERMONT CENTRAL RESERVATIONS**  
T 0860 777 900 (SA only)  
+27 (0)11 928 1928  
reservations@peermont.com

FOLLOW US

